

POCKETFUL OF DREAMS

Christmas Card Instructions
Diamond bauble card 135 x 135mm



A CRAFTED
CHRISTMAS

What you will need

- A pair of scissors
- Cutting mat
- Craft knife
- Metal ruler
- An A4 printer
- A4 white card (at least 300gsm, check your printer for card weight specifics)
- PVA glue
- Glitter (we like gold, but any colour will do)
- Thin wire, twine or yarn of your choice

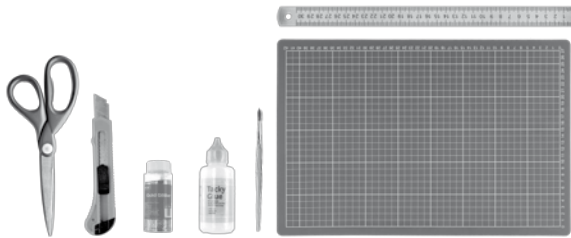

Let's get crafty

- 1 Print the downloaded A4 artwork and select your favourite bauble (we know, this bit is difficult!).



**TOP
TIP**

**TO ACHIEVE A GOOD QUALITY PRINT
TRY & USE A PREMIUM PAPER STOCK.
SELECT AT LEAST 300GSM. WE USED
PHOTOGRAPHIC INK-JET PAPER.**

- 2 Cut, score and fold all the artwork elements; you should have the card and chosen bauble. Use the crop marks to line up your ruler and then using the back of your blade, score down the centre of the card.
- 3 Use the point of the blade to make a very small hole on the front of the card and the hanging diamond. Use the dots on the artwork to guide you.
- 4 Glue all the glitter areas on the artwork using a small brush.
- 5 Gently shake on the glitter. Wait a few seconds and then tip it off.
- 6 Use a small piece of wire to thread through the hole to attach the bauble shape. Twist at the back to fasten and if you wish add a little clear tape to fix in place.
- 7 We've left the card blank for you to add your own festive message.
- 8 Try World of Envelopes online store for gold and hot pink square envelopes in a 140 x 140mm size.
www.worldofenvelopes.com

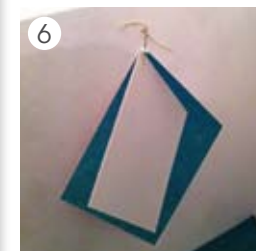
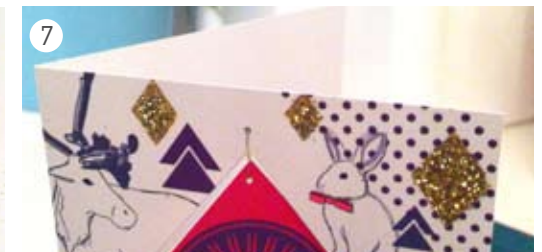
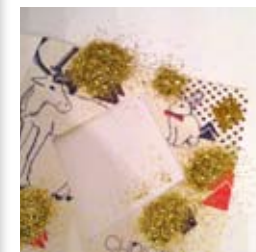
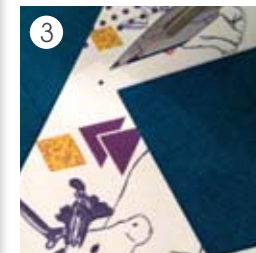
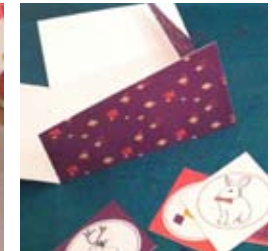
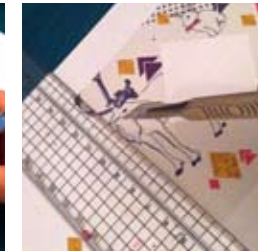
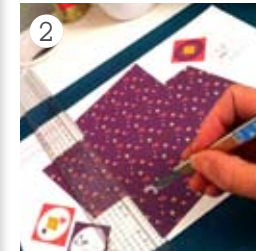

POCKETFUL OF DREAMS

Card 135 x 135mm folded size
Card design artwork



Designed exclusively for
POCKETFUL OF DREAMS
by Jennifer Newman
BONJOURPONY



POCKETFUL OF DREAMS

Card 135 x 135mm folded size
Bauble design artwork

